



SCHOTT
glass made of ideas

KIMAX®
Laboratory Glass Pipe

Price List
February T-2015

Albert Sterling & Associates, Inc.
5613 Winsome Lane
Houston TX, 77057

713-780-1600 (phone)
713-780-8933 (fax)

chrisw@albertsterling.com
vicsjr@albertsterling.com

Drainline Pipe and Fittings

Straight lengths –
Pipe 6500 5-ft. lengths

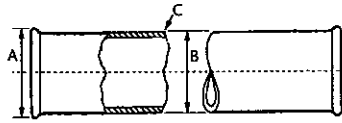

6511
Sweeps

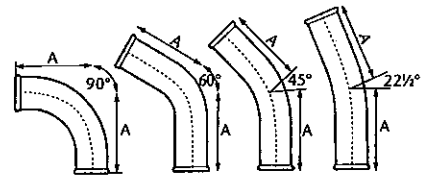

Article	Size	Price (\$)
6500-1500	1½" x 5'	80.10
-2000	2" x 5'	107.45
-3000	3" x 5'	144.80
-4000	4" x 5'	264.80
-6000	6" x 5'	465.55

Article	Size	Price (\$)
6501-1500	1½" x 10'	149.10
-2000	2" x 10'	202.65
-3000	3" x 10'	278.20
-4000	4" x 10'	560.15
-6000	6" x 10'	907.50

Article	Size	Price (\$)
6511-1590	1½" - 90°	42.60
-2090	2" - 90°	53.90
-3090	3" - 90°	88.75
-4090	4" - 90°	141.85
-6090	6" - 90°	431.85

6511-1560	1½" - 60°	42.60
-2060	2" - 60°	53.90
-3060*	3" - 60°	88.75
-4060*	4" - 60°	141.85
-6060*	6" - 60°	431.85

6511-1545	1½" - 45°	42.60
-2045	2" - 45°	53.90
-3045	3" - 45°	88.75
-4045	4" - 45°	141.85
-6045	6" - 45°	431.85

HW 7035-P EPS** Covers

5-ft. length = 4 pieces
(for underground use)

** Expanded Polystyrene

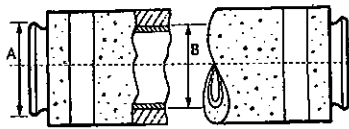

Article	Size	Price (\$)
HW7035-P-1500	1½" x 5'	8.55
-2000	2" x 5'	7.45
-3000	3" x 5'	7.95
-4000	4" x 5'	9.25
-6000	6" x 5'	15.25

6511-1522	1½" - 22½°	42.60
-2022*	2" - 22½°	53.90
-3022*	3" - 22½°	88.75
-4022*	4" - 22½°	141.85
-6022*	6" - 22½°	431.85

Drainline Pipe and Fittings

6513 Bends

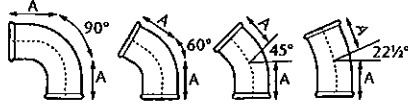

Article	Size	Price (\$)
6513 -1590	1½" - 90°	44.10
-2090	2" - 90°	55.60
-3090	3" - 90°	91.10
-4090	4" - 90°	141.85
6513 -1560	1½" - 60°	44.10
-2060	2" - 60°	55.60
-3060*	3" - 60°	91.10
-4060*	4" - 60°	141.85
6513 -1545	1½" - 45°	44.10
-2045	2" - 45°	55.60
-3045	3" - 45°	91.10
-4045	4" - 45°	141.85
-6045	6" - 45°	392.60
6513 -1522	1½" - 22½°	44.10
-2022	2" - 22½°	55.60
-3022*	3" - 22½°	91.10
-4022*	4" - 22½°	141.85

6521 Single Sanitary T

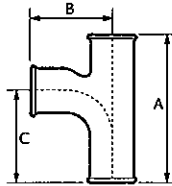

Article	Size	Price (\$)
6521 -1515	1½" x 1½"	68.85
-2015	2" x 1½"	68.85
-2020	2" x 2"	68.85
-3015	3" x 1½"	90.85
-3020	3" x 2"	100.35
-3030	3" x 3"	102.75
-4015	4" x 1½"	137.45
-4020	4" x 2"	148.65
-4030	4" x 3"	158.50
-4040	4" x 4"	184.10
-6020*	6" x 2"	346.35
-6030*	6" x 3"	382.00
-6040*	6" x 4"	384.50
-6060	6" x 6"	493.15

6522 Double Sanitary T

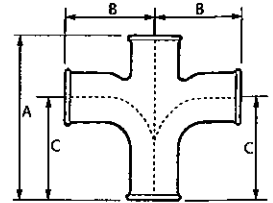

Article	Size	Price (\$)
6522 -1515	1½" x 1½"	102.75
-2015	2" x 1½"	102.75
-2020	2" x 2"	102.75
-3015*	3" x 1½"	132.50
-3020	3" x 2"	144.60
-3030	3" x 3"	154.35
-4015*	4" x 1½"	239.45
-4020*	4" x 2"	243.40
-4030*	4" x 3"	264.60
-4040*	4" x 4"	297.40
-6020*	6" x 2"	377.25
-6030*	6" x 3"	418.50
-6040*	6" x 4"	477.55
-6060*	6" x 6"	605.00

6523 Straight T

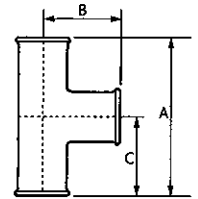

Article	Size	Price (\$)
6523 -1515	1½" x 1½"	85.20
-2015	2" x 1½"	85.20
-2020	2" x 2"	85.20
-3015	3" x 1½"	107.65
-3020	3" x 2"	110.15
-3030	3" x 3"	123.00
-4015*	4" x 1½"	140.85
-4020	4" x 2"	147.10
-4030*	4" x 3"	197.20
-4040	4" x 4"	216.10
-6030*	6" x 3"	452.10
-6040*	6" x 4"	466.20
-6060*	6" x 6"	531.50

Drainline Pipe and Fittings

6524 Test T with Cleanout

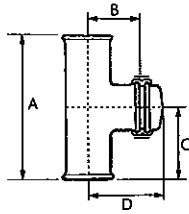

Article	Size	Price (\$)
6524 -1515	1½" x 1½"	114.10
-2020	2" x 2"	132.70
-3030	3" x 3"	182.90
-4040	4" x 4"	352.55

Test Tee and cleanout comes as complete assembly including cap and coupling.

6526 Single Drainline Y

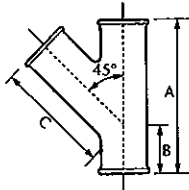

Article	Size	Price (\$)
6526 -1515	1½" x 1½"	72.50
-2015	2" x 1½"	72.50
-2020 *	2" x 2"	72.50
-3015	3" x 1½"	98.10
-3020 *	3" x 2"	101.00
-3030 *	3" x 3"	116.35
-4015 *	4" x 1½"	151.45
-4020	4" x 2"	152.75
-4030	4" x 3"	172.50
-4040	4" x 4"	193.50
-6020 *	6" x 3"	331.30
-6030 *	6" x 2"	408.90
-6040 *	6" x 4"	441.10
-6060 *	6" x 6"	493.30

6527 Double Drainline Y

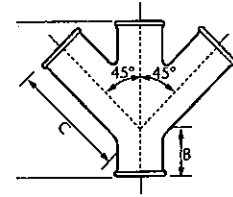

Article	Size	Price (\$)
6527 -1515 *	1½" x 1½"	140.70
-2015 *	2" x 1½"	140.70
-2020 *	2" x 2"	140.70
-3015 *	3" x 1½"	140.70
-3020 *	3" x 2"	179.20
-3030 *	3" x 3"	209.60
-4015 *	4" x 1½"	229.30
-4020 *	4" x 2"	246.40
-4030 *	4" x 3"	306.75
-4040 *	4" x 4"	353.15
-6020 *	6" x 2"	532.10
-6030 *	6" x 3"	560.00
-6040 *	6" x 4"	590.00
-6060 *	6" x 6"	1,078.00

6528 Single Combination Y and 1/8 Bend

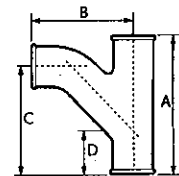

Article	Size	Price (\$)
6528 -1515	1½" x 1½"	91.85
-2015	2" x 1½"	91.85
-2020	2" x 2"	91.85
-3015	3" x 1½"	101.00
-3020 *	3" x 2"	125.75
-3030 *	3" x 3"	128.05
-4015	4" x 1½"	144.25
-4020	4" x 2"	154.35
-4030	4" x 3"	175.00
-4040	4" x 4"	205.95
-6020 *	6" x 2"	332.30
-6030 *	6" x 3"	393.70
-6040 *	6" x 4"	394.40
-6060 *	6" x 6"	465.80

Drainline Pipe and Fittings

6529

Double Combination Y and 1/8 Bend

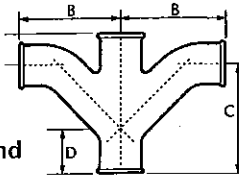

Article	Size	Price (\$)
6529-1515	1½" x 1½"	123.15
-2015	2" x 1½"	126.00
-2020	2" x 2"	155.50
-3015*	3" x 1½"	182.40
-3020*	3" x 2"	175.15
-3030*	3" x 3"	231.85
-4015*	4" x 1½"	253.00
-4020*	4" x 2"	251.15
-4030*	4" x 3"	291.05
-4040*	4" x 4"	404.75
-6020*	6" x 2"	457.00
-6030*	6" x 3"	491.00
-6040*	6" x 4"	582.00
-6060*	6" x 6"	789.65

6537

Eccentric Reducers or Increases

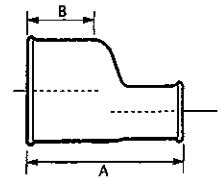

Article	Size	Price (\$)
6537-2015	2" x 1½"	41.05
-3015*	3" x 1½"	73.15
-3020*	3" x 2"	64.00
-4015*	4" x 1½"	150.85
-4020*	4" x 2"	117.00
-4030*	4" x 3"	130.75
-6015*	6" x 1½"	265.95
-6020*	6" x 2"	282.80
-6030*	6" x 3"	292.95
-6040*	6" x 4"	301.10

6531

Partition Cross (Compact)**

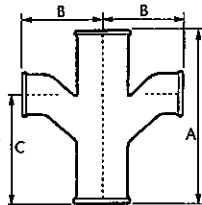

Article	Size	Price (\$)
6531-2015*	2" x 1½"	149.45
-2020*	2" x 2"	149.45
-2151*	2" x 1½" x 1½" x 1½"	171.15

** Partition crosses are designed to prevent cross-flow when sinks are connected back to back.

6544

Cleanout Plug



Article	Size	Price (\$)
6544-1500	1½"	17.85
-2000	2"	22.50
-3000	3"	32.20
-4000	4"	58.00
-6000	6"	84.60

6536

Straight Reducers or Increases

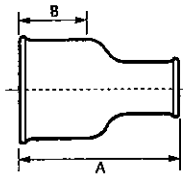

Article	Size	Price (\$)
6536-2015	2" x 1½"	37.20
-3015	3" x 1½"	55.70
-3020	3" x 2"	62.15
-4015*	4" x 1½"	86.80
-4020	4" x 2"	92.00
-4030	4" x 3"	99.45
-6015*	6" x 1½"	252.00
-6020*	6" x 2"	267.85
-6030	6" x 3"	286.30
-6040	6" x 4"	294.30

6550

U Bend (vent loop)

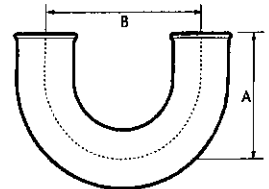

Article	Size	Price (\$)
6550-1500	1½"	75.25
-2000	2"	93.95
-3000	3"	190.75
-4000*	4"	264.30

* Subject to stock availability / manufactured per order, not returnable

Drainline Pipe and Fittings

6566 "MJ" Pipe Adapter

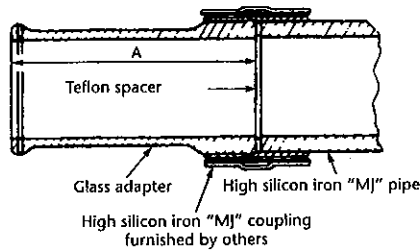

Article	Size	Price (\$)
6566-1500	1½"	86.70
-2000	2"	90.10
-3000	3"	143.45
-4000	4"	213.55

Line Cup Sinks

6619 beaded outlet 3" x 6" oval

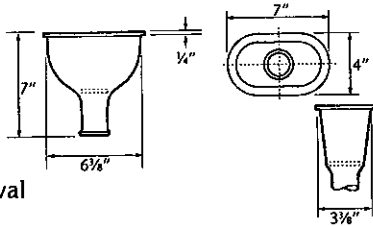

Article	Size	Price (\$)
6619-3600		118.00

6619P plain end outlet 3" x 6" oval

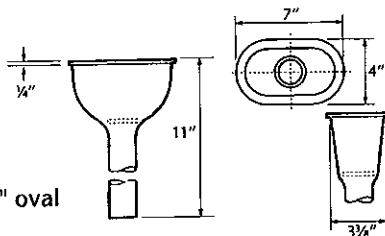

Article	Size	Price (\$)
6619P-3611		135.65

6724 Sink Strainer (All Cup Sinks)

Article	Size	Price (\$)
6724-1500	1½"	18.35
-2000	2"	21.80

Drainline Couplings

6650 Drainline Coupling (Bead to Bead)

No. 6650 Drainline Couplings is used for joining 1½", 2", 3", 4", and 6" KIMAX Glass Drainline pipe and fittings. Patented

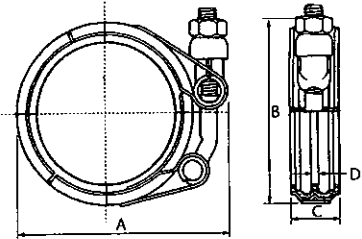

Article	Size	Price (\$)
6650-1500	1½"	31.70
-2000	2"	39.90
-3000	3"	53.75
-4000	4"	92.45
-6000	6"	207.50

6655 Adapter Coupling

No. 6655 Adapter Couplings is used to join KIMAX drainline pipe and/or fittings to plain end sink tailpieces. Patented Pending

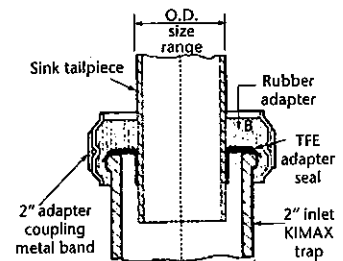

Article	Size	Price (\$)
6655-2015	2" x 1½"	55.85
-2017	2" x 1¾"	55.85
-2018	2" x 1⅞"	55.85

6661 B/P Drainline Coupling (Bead to Plain End)

No. 6661 B/P Drainline Coupling is used for joining 1½", 2", 3", 4", and 6" KIMAX beaded glass drainline to plain end (cut) glass pipe, lead, I.P.S. metal, or plastic pipe.

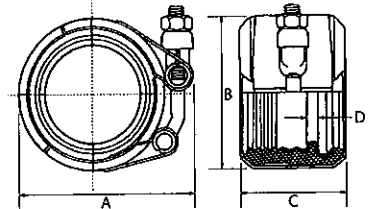

Article	Size	Price (\$)
6661-1500	1½"	40.70
-2000	2"	50.75
-3000	3"	86.15
-4000	4"	128.55
-6000	6"	434.70

Drainline Couplings

6665

Adapter Coupling

Used to join 1½" beaded KIMAX drainline pipe to 1¼" or 1½" O.D. tubing.

Note: Rubber seal only – not recommended where acids will come in contact with the coupling seal.

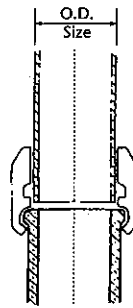

Article	Size	Price (\$)
6665 - 1512*	1½" x 1¼"	47.90
- 1515	1½" x 1½"	47.90

6704

Swivel Trap – P Style (Plain End Outlet*)

No. 6704 (plain end outlet) Swivel "P" Trap

* Plain end outlet can be field cut

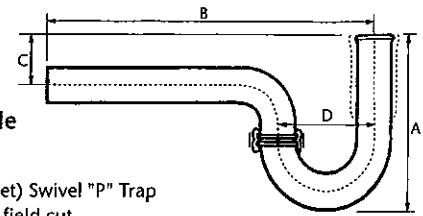

Article	Size	Price (\$)
6704 - 1515	1½" x 1½"	152.95
- 2015	2" x 1½"	165.70
- 2020	2" x 2"	194.70

Drainline Traps F**

6700

Swivel Trap – P Style

No. 6700 (short outlet) Swivel "P" Trap

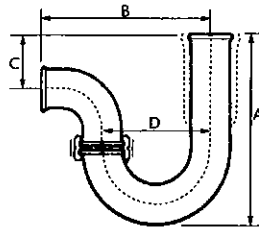

Article	Size	Price (\$)
6700 - 1515	1½" x 1½"	131.40
- 2015	2" x 1½"	143.90
- 2020	2" x 2"	169.95

6706

Swivel Trap – S Style

No. 6706 Swivel "S" Trap

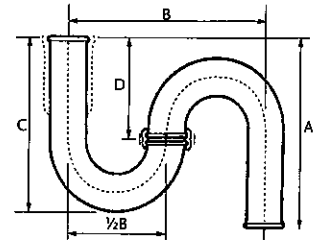

Article	Size	Price (\$)
6706 - 1515	1½" x 1½"	152.25
- 2015	2" x 1½"	164.70
- 2020	2" x 2"	199.10

Components pricing

6705 - 1515	65.30
- 2015	80.15
- 2020	85.80

6701

Swivel Trap – P Style

No. 6701 (long outlet) Swivel "P" Trap

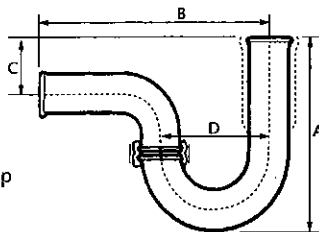

Article	Size	Price (\$)
6701 - 1515	1½" x 1½"	148.45
- 2015	2" x 1½"	165.70
- 2020	2" x 2"	194.70

6707

Drum Trap – P Style

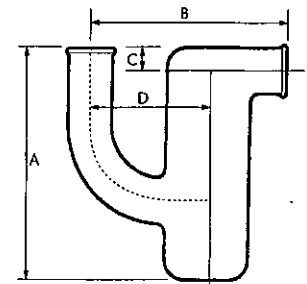

Article	Size	Price (\$)
6707 - 1515*	1½" x 1½"	206.10
- 2015*	2" x 1½"	276.45
- 2020*	2" x 2"	285.80

* Subject to stock availability/manufactured per order, not returnable

** Expanded inlets of traps have 4" minimum depths to permit adjustment.

Drainline Traps**

6708

Interceptor Trap

A: Adapter Coupling
No. 6665-1512 (to connect
to 1 1/4" O.D. tubing)

B: Perforated S.S. Screen 1/16"
dia. holes 6 sq. in. free area opg.

C: Removable coupling / end cap for cleanout.

D: Min. 3" clearance required under trap for removal of end cap.

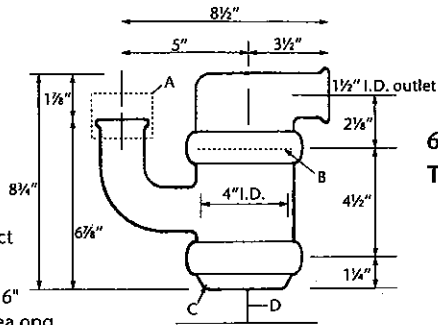

6718

Trap – P Style

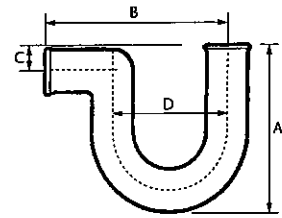

Article	Size	Price (\$)
Interceptor Trap		
6708 -4015	1 1/2" x 1 1/2"	497.85
Components		
6544 -4000	4" Cleanout Plug	58.30
6650 -4000	4" Bead to Bead Coupling	92.45
Outlet		
6716 -4000*	4" x 1 1/2"	115.15
Inlet		
6715 -4000*	1 1/2" x 4"	146.70
Coupling with Strainer		
6667 -4000	4"	184.60

Article	Size	Price (\$)
6718 -1515	1 1/2" x 1 1/2"	96.65
-2015*	2" x 1 1/2"	104.50
-2020	2" x 2"	126.60
-3030	3" x 3"	259.60
-4040	4" x 4"	388.40
-6060*	6" x 6"	1,488.40

* Has expanded inlet. Use No. 6655 adapter coupling for inlet joint.

6710

Swivel Drum Trap – P Style

No. 6710 Swivel Drum Trap "P"

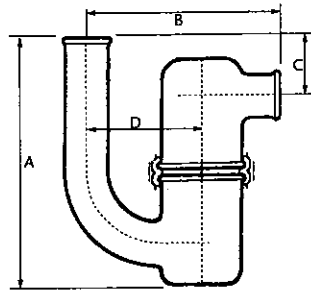

Article	Size	Price (\$)
6710 -1515	1 1/2" x 1 1/2"	234.20
-2015	2" x 1 1/2"	251.00
-2020	2" x 2"	291.05
Components List		
Inlet		
6715 -1530	1 1/2" x 3"	123.45
-2030	2" x 3"	122.05
-2040	2" x 4"	151.70
Outlet		
6716 -3015	3" x 1 1/2"	90.25
-4015	4" x 1 1/2"	99.20
-4020	4" x 2"	113.40

Accessories and Hardware

6680 Thread Adapters (Threaded to Beaded Pipe)

Thread Adapters are used to provide beaded end on threaded pipe for connecting directly to KIMAX glass drainlines with No. 6650 coupling. All TFE construction. Adapter No. 6680 will fit standard straight or tapered threads. Used for same size pipe (e.g. 1½" metal to 1½" glass) ideal for floor drain connections. In 1½", 2", 3", and 4" sizes.

Article	Size	Price (\$)
6680-1500	1½"	42.60
-2000	2"	53.20
-3000	3"	74.80
-4000	4"	127.40

6685 Adjustable Thread Adapter

Adapter No. 6685 is designed to mate 1½" threaded tailpieces to 2" expanded inlets of KLIMAX traps. Can be moved up and down on tailpiece for space adjustments. In 2" x 1½" size only

Article	Size	Price (\$)
6685-2015	2" x 1½"	61.25

6720 Sink Outlet Assembly (1½" Size)

Consists of:
6724 sink strainer (black fluorocarbon plastic) 1½" or 2"
6721 and 6721D sink outlet (black fluorocarbon plastic)
6725 gasket-neoprene
6722 locknut

Note: Hand tighten 6722 locknut to sink. DO NOT USE PIPE WRENCH. To fill gap in sink counterbore, use 3M-EC-612 caulking compound or equivalent. 1½" and 2" size sink outlets are designed to accept standard overflows.

Article	Size	Price (\$)
6720-1500	1½"	276.45
-2000*	2"	515.30
6724-1500	1½"	18.35
-2000	2"	21.80

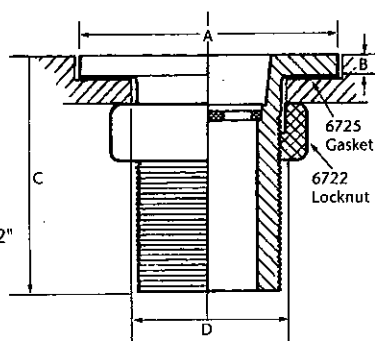
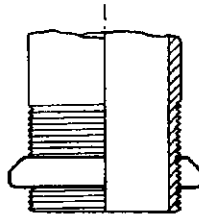
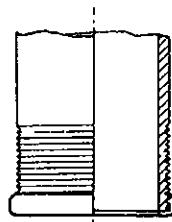

6500 S 264 Tailpiece

Connection to the sink strainer assembly is accomplished using a 6661-1500 Bead x Plain End coupling. Tail Piece can be cut to desired length using the standard KIMAX® glass cutter.

Article	Size	Price (\$)
6500 S 264	1½" x 1½"	21.75

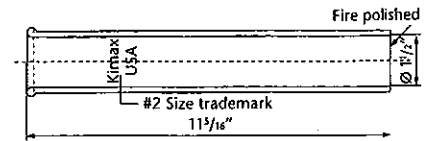

6735 1½" Split Coupling (Threaded to Beaded Pipe)

No. 6735, 1½" Split Coupling is used to join 1½" beaded glass pipe to a threaded 1½" I.P.S. pipe.

To install ... remove clamp from split nut. Place split nut over beaded glass end. Replace clamp and tighten with screw driver.

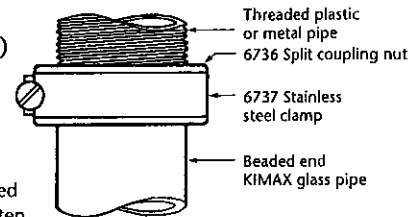

* Use gasket No. 6739 when connecting KIMAX glass pipe to threaded metal pipe, using No. 6735 split coupling.

Article	Size	Price (\$)
6735-1500	1½"	41.05

6739 Gasket

Use gasket No. 6739 when connecting KIMAX glass pipe to threaded metal pipe, using No. 6735 split coupling.

Article	Size	Price (\$)
6739-1500	1½"	14.70

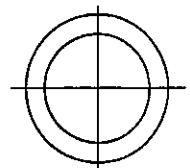

Accessories and Hardware

7290 (1½", 2", 3", 4", 6" sizes)

Pipe Hangers (padded)

Recommended for horizontal runs.

Hangers contain integral cushions.

Standard finish on band is A.S.T.M. type L.S. zinc coating.

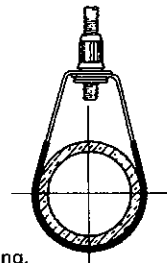

Article	Size	Price (\$)
7290-1500	1½"	9.35
-2000	2"	10.70
-3000	3"	17.95
-4000	4"	30.00
-6000	6"	60.85

7310-56802 KIMAX Portable Glass

Pipe Cutter 1½" – 6"

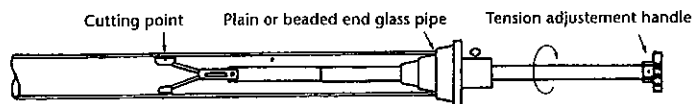

Complete cutter

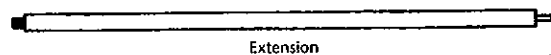

Extension



Scoring head assembly 1½" – 2" – 3" – 4" and 6" diameters Article No. 7310-F-5000

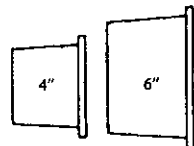

Centering cones
Order 6" centering cone separately

With the KIMAX Portable Glass Pipe Cutter you can cut 1½" – 6" glass drainline pipe anywhere on the job site. Complete cutter consists of a scoring head assembly, extension, tension arm subassembly and 1½" – 4" centering cones and ring stop as shown. Order 6" centering cone separately.

Case Quantities and Weight per Case

Article	Size	Case Qty.	Approx. Wt.			
Pipe-Straight Lengths						
6500	1500	4	1½"	lbs.	per	ft.
6501	2000	4	1½"	"	"	"
Sweeps or Bends						
6511	All 1½"	12	9	lbs.	per	ft.
	All 2"	8	12	"	"	"
	All 3"	2	6	"	"	"
	All 4"	1	6	"	"	"
	All 6"	1	13	"	"	"
6513	All 1½"	18	9	"	"	"
	2"	12	7	"	"	"
	3" 90° only	3	7	"	"	"
	Other than 90°	4	12	"	"	"
	4"	1	6	"	"	"
	6"	1	13	"	"	"
Sanitary T						
6521	1½"	12		15		
6522	1½"	8		12		
6523	1½"	12		15		
	2"	6		9		
	3"	2		8		
	4"	1		8		
	6"	1		15		
Y Branch						
6526	1½"	12		12		
	2"	6		9		
	3"	2		8		
2627	1½"	8		12		
Com Y and 1/8"						
6528	1½"	12		12		
	2"	6		9		
	3" x 1½"	2		8		
	3" x 3"	1		7		
	4"	1		6		
6529	1½"	8		12		
Partion Cross						
6531	2"	4		5		
Reducers						
6536	2"	18		9		
&	3"	6		9		
6537	4"	1		3		
	6"	1		6		
Cleanout Plugs						
6544	1½"	36		5		
	2"	36		12		
	3"	27		9		
	4"	18		18		
	6"	1		1		
U Bend						
6550	1½"	8		10		
	2"	4		10		
	3"	2		7		
	4"	1		11		
"MJ" Pipe Adapter						
6566	1½"	8		6		
	2"	6		7		
	3"	1		2		
	4"	1		3		
6619		1		3		
6619P		1		3		

Article	Size	Case Qty.	Approx. Wt.
Swivel P Trap			
6700	1½"	4	9
	2" x 1½"	4	12
	2"	2	6
6701-1515	1½"	4	9
6701-2015	2" x 1½"	4	12
6701-2020	2"	2	6
6704	2"	2	8
6706	1½"	4	9
	2"	2	6
6707-1515	1½"	1	5
6707-2015	2" x 1½"	1	6
6707-2020	2"	1	9
Swivel Drum Trap P Style			
6710	1½"	1	5
	2" x 1½"	1	6
	2" x 2"	1	9
P Trap			
6718	1½"	4	8
	2"	4	9
	3"	1	6
	4"	1	10
	6"	1	18
Interceptor Trap			
6708	4015	1	10
Partition Trap			
6614	2"	1	5
Couplings			
6650	1½"	50	14
	2"	50	17
	3"	24	13
	4"	24	24
	6"	10	23
6655	All sizes	50	18
6661	1½"	50	21
	2"	50	25
	3"	20	20
	4"	12	23
	6"	5	24
Sink Outlet Assy.			
6720	All sizes	12	8
6720D-2000	All sizes	12	8
Accessories and Hardware			
6500 S 264	11½" x 1½"	4	4

Items not listed are packed in quantity ordered. Distributed by:

"Specifications, dimensions and tolerances of all components – pipe, fittings and couplings – as illustrated in this publication, are engineered for safety and product performance reasons as a total SCHOTT Acid Waste Drainline System Interchanging these SCHOTT components with similar products manufactured by others, in acid waste drainline systems voids all SCHOTT warranties of product performance and integrity with respect to such components."

SCHOTT North America, Inc. reserves the right to modify or delete at any time, products as illustrated and described in the publication.

The information contained in this brochure is believed to be accurate and is offered in good faith by SCHOTT North America, Inc. However, suitability of our products for a given field application is the responsibility of the buyer and SCHOTT North America, Inc. accepts no liability for the appropriateness or adequacy of its products or information for any specific installation. Orders are subject exclusively to our standard terms and conditions of sale. Prices are F.O.B. Warehouse, Wilkes-Barre, PA 18702 and are subject to change without notice.